



Model Number:  
**F-NPCX-714172**

RF Components

# C-Band Band Pass Waveguide Filter

## 3840-4800MHz

Physical Dimensions ( $\pm 0.3\text{mm}$ )

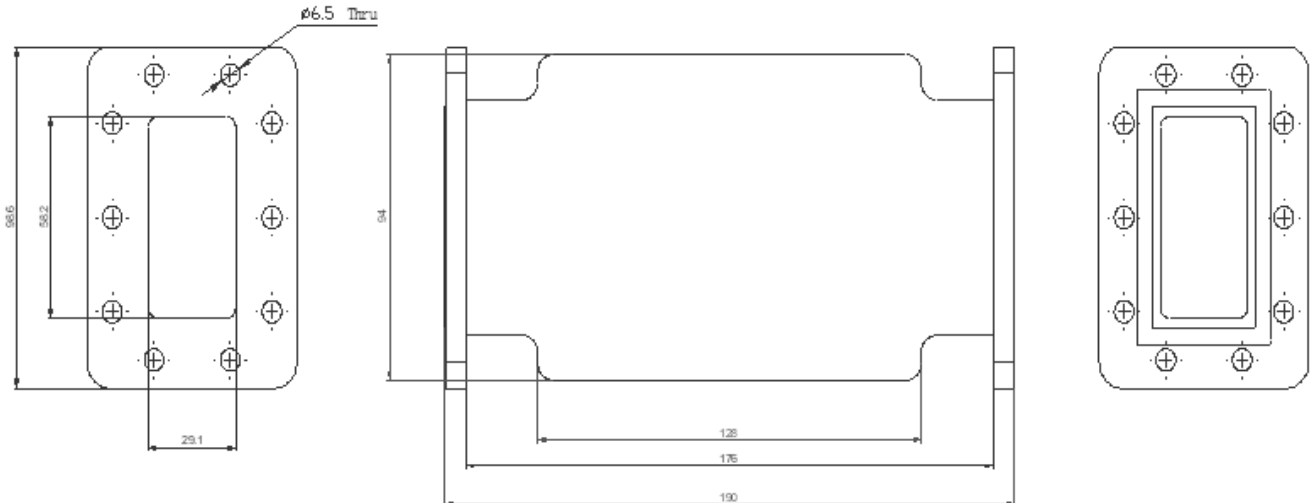

# Filter

RF Parameters	
F-NPCX-714172	CGCF
Band Pass Frequencies	3840-4800MHz
Rejection	$\geq 90$ @DC-3400MHz $\geq 70$ @3400-3600MHz $\geq 60$ @3600-3800MHz $\geq 30$ @4900-5000MHz $\geq 60$ @5000-5100MHz $\geq 90$ @5100-5600MHz
Insertion Loss (dB)	Max $\leq 0.6$ @3840-4000MHz $\leq 0.4$ @4000-4800MHz
VSWR	Max 1.4:3
Connectors	CPR229F/ CPR229G
Power Handling	Max 100W

Environmental	
Operating Temperature	-20 °C to +50°C
Location	For Indoor or Outdoor use
IP Rating	IP65

### Broadcast



### Marine Oil & Gas



### SNG & VSAT



### Satellite Teleport

